

Redesigning the Casa Museo Ismael Rivera Park

NATE DIXON, SPENCER GRANLUND, SCOTT PENA, ANDREW
SOSA





El Comienzo - The Beginning



Project Objectives



Analysis of Current Casa Museo Lawn Conditions.

Involve Stakeholders in Participatory Design for Input and Feedback.



Generate CAD Drawings of Park Designs to Share with Stakeholders.

Create a Cost Estimation Tool to Estimate Prices of Design Concepts



Clean-up!



Casa Museo Ismael Rivera Caja de Recuerdos

La Casa Museo Ismael Rivera es un lugar querido para El Barrio Machuchal en Santurce que ayuda a preservar y difundir la carrera de Ismael "El Sonero Mayor" Rivera. La Casa Museo ha traído mucha felicidad a la comunidad a través de su liderazgo y eventos animados. Después de los desafortunados eventos del huracán María en 2017, el lote delante de la Casa Museo quedó destruido: los árboles caídos, basura por todo el lote y la cerca se derrumbó. El lote necesita mantenimiento y rediseño para que le permita a la Fundación Ismael Rivera tener un lugar donde puedan realizar eventos para el barrio.

Somos un equipo de estudiantes universitarios del Worcester Polytechnic Institute (WPI) en Massachusetts. Estaremos en Puerto Rico hasta el 3 de mayo trabajando con Taller Creando Sin Encargos para recopilar opiniones de la comunidad sobre las visiones para la renovación del lote de Casa Museo. Invitamos a cualquier persona a poner sus recuerdos de Ismael Rivera, Doña Margot, la Casa Museo y los eventos que se realizaron anteriormente en el frente del lote. También nos gustaría que contribuyeras con ideas sobre lo que podría incluir un nuevo parque. ¡Siéntase libre de agregar cualquier sugerencia que le gustaría ver implementada en el rediseño del lote frontal de la Casa Museo!

Nate Dixon, Spencer Granlund, Scott Pena, Andrew Sosa
Contacta con nosotros en: gr-prd23-rivera@wpi.edu

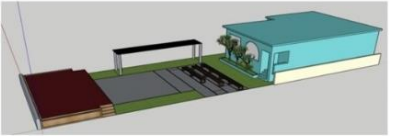

TE INVITAMOS A
Un proceso de diseño participativo



Frente a la
Casa Museo
Ismael Rivera

Jueves
30 de marzo de 2023 // de 6:30pm a 7:30pm
Queremos escuchar tu voz

Convocamos a toda la comunidad para escuchar sus ideas para el diseño de un espacio público en el lote frente a la Casa Museo Ismael Rivera

Casa Museo Ismael Rivera, Cll Ismael Rivera,
#2003 Callejón Concordia, San Juan, 00911,
Puerto Rico

Project Promotion

Design Methodology: Participatory Design



Memory Box



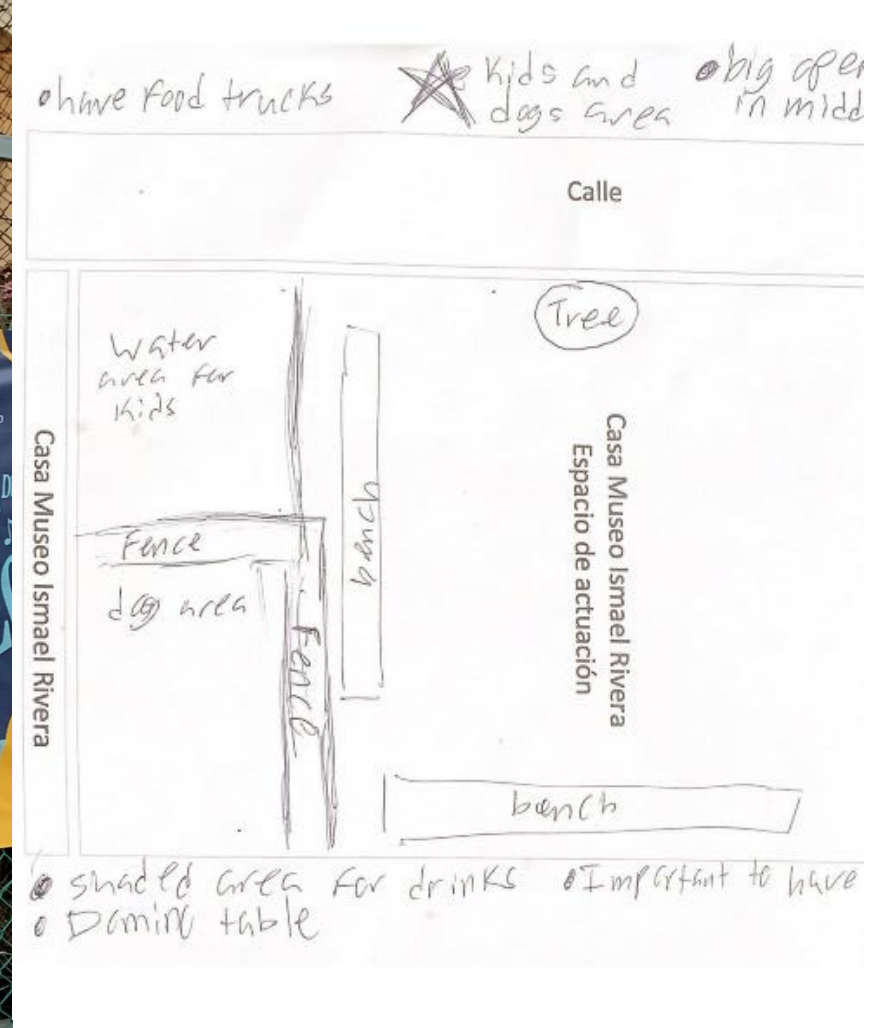

Participatory Park Mapping



Image Ranking



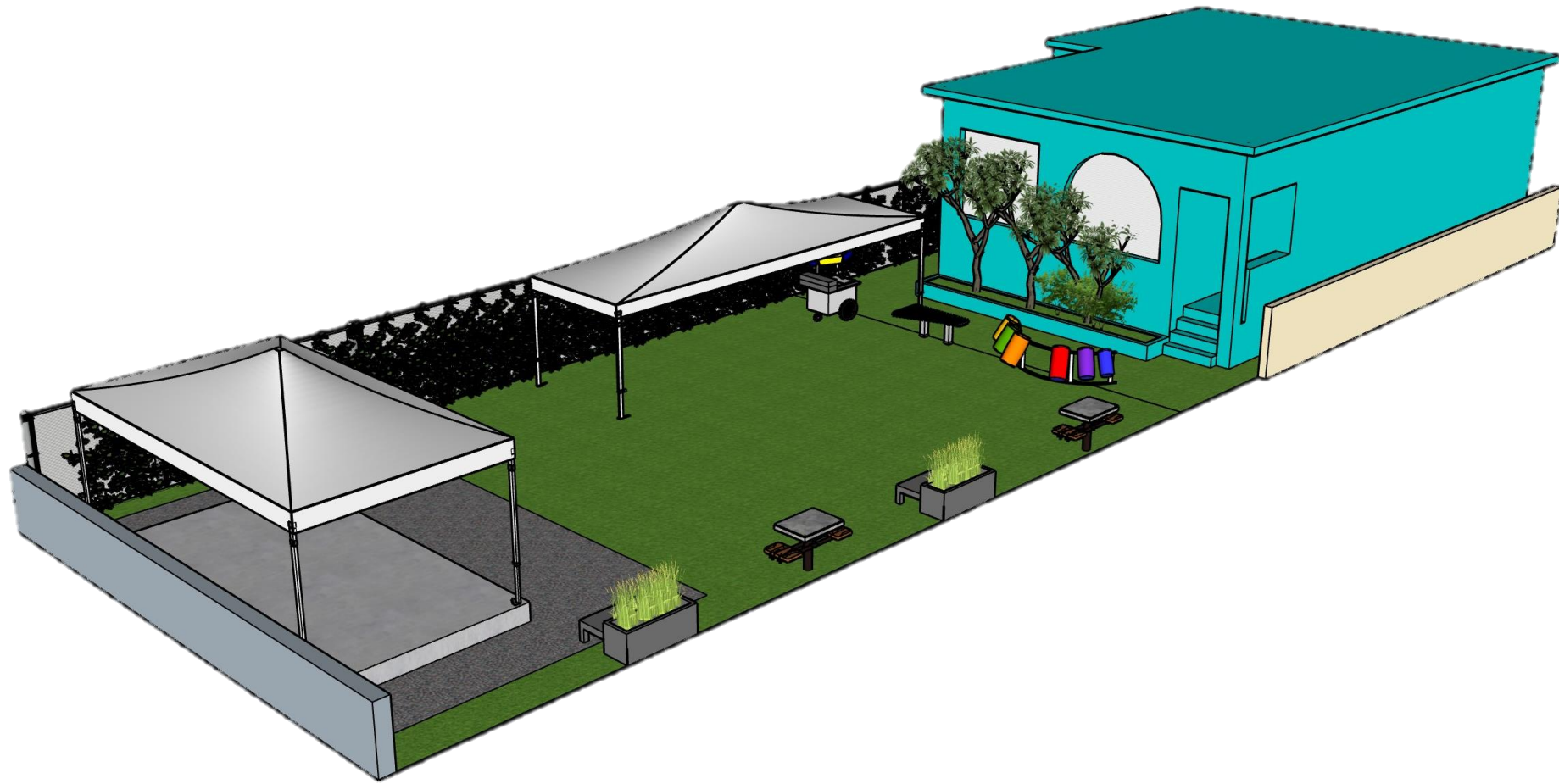

Final Design Iteration

DESIGN 2: Water Feature & Dog Park

This design for the park provides a large open space for people to gather in the center of the park while still having areas for seating. This layout also implements some unique features such as the domino tables, a dog area, and a water feature. This design was based off feedback by one community member and was the second highest voted design in the image ranking activity.

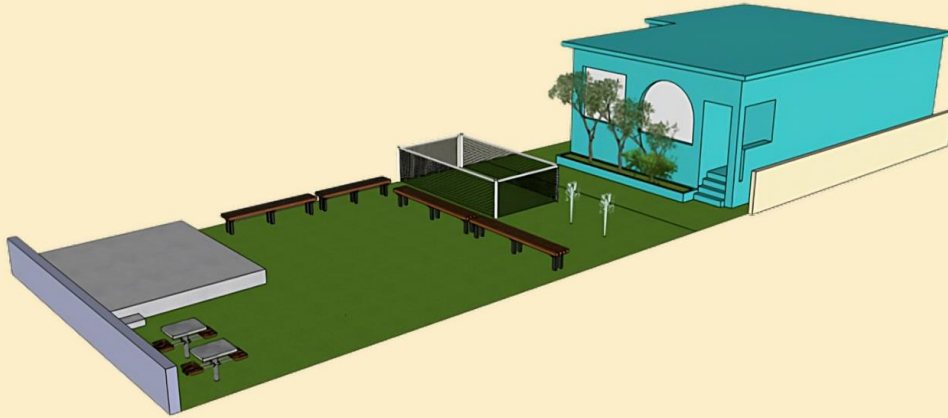

28

DESIGN 3: Open Performance Space

This park layout, based off feedback from Ivelisse Rivera, leaves a significant amount of open space for people to gather and host events. The planters on the side double as small benches to provide seating for those in the park that would want it and function as a barrier to stop cars from parking on the lot. There are also musical instruments mounted in the park for kids to play with and enjoy. This layout also provides plenty of room for people to set up stands or kiosks during an event. This was the most voted for design in the image ranking activity.

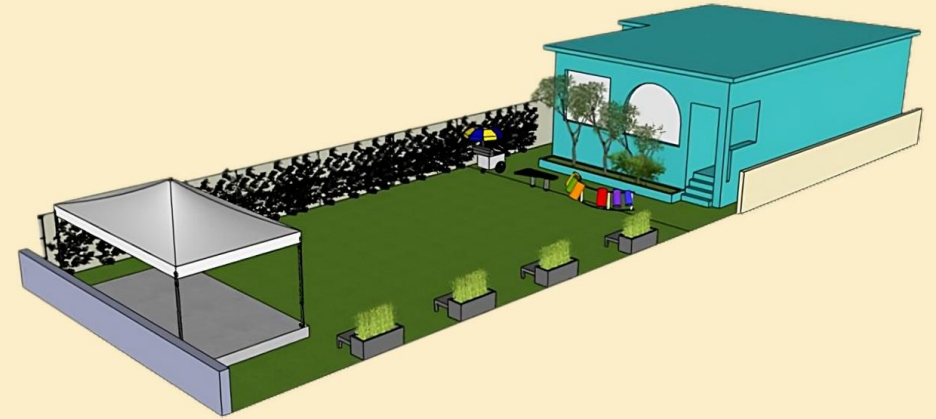

34

Top Design Outcomes

COVERED STAGE

The stage would be a place for local artists to perform during events at the Casa Museo and once again celebrate the legacy of Ismael Rivera. Before Hurricane Maria, the park used to host numerous public events to celebrate Puerto Rican art and culture and Ismael Rivera's impact. In the past, the community held many musical performances during these events, so the stage would be one of the most important pieces to bring that kind of celebration back to the Ismael Rivera Casa Museo lot. We believe it is crucial for the park to have an area for artists to celebrate the local music and culture.

In the design, the covering would provide some much-needed shade in the park. When not being used, the stage would serve as another shaded area for residents to socialize. In this design, the stage would be made from concrete to make it durable and low maintenance. The stage would be simple and in the shape of a rectangle to keep the price down while still being aesthetically pleasing, as well as being at a low height for additional seating options. In this model, it is in the center of the back wall with a covering to provide shade for the performers and protect them from the rain. The participants of the Participatory Mapping activity unanimously chose this location. The simple design also allows for more innovation surrounding the feature, such as adding speakers for performers, or adding string lights across the tent to add lighting in the park at night.



STAGE OPTIONS



Pocket Park Design Portfolio

How to Use: Input desired dimensions for a park feature shown in the grey cells. Choose between the various costs calculated.

Stage				
Length (ft): 10	Width (ft): 20	Square Feet: 200		
Stamped Concrete Slab				
Type	Cost per sq. ft.		Low Price (total)	High Price (total)
Basic	\$ 9	\$ 13	\$ 1,800	\$ 2,600
Mid-End	\$ 14	\$ 19	\$ 2,800	\$ 3,800
High-End	\$ 20		\$ 4,000	
Polished Concrete Slab				
Type	Cost per sq. ft.		Low Price (total)	High Price (total)
Basic	\$ 2	\$ 7	\$ 400	\$ 1,400
Mid-End	\$ 5	\$ 10	\$ 1,000	\$ 2,000
High-End	\$ 8	\$ 16	\$ 1,600	\$ 3,200

Benches		
Length (ft):	Width (ft):	Height (ft):
10	1	1
Concrete		
Bench Cost:		\$ 4,500
Wood		
Bench Cost:		\$ 3,000

Gravel		
Length (ft):	Width (ft):	Total Area
2	6	12
Type:	Min Price	Max Price
Crushed Granite	\$ 12	\$ 36
Crushed Limestone	\$ 18	\$ 24
Caliche	\$ 5	\$ 78
Pea Gravel	\$ 12	\$ 38

Pocket Park Cost Estimator



Next Steps

Acknowledgments

Omayra Rivera Crespo &
Taller Creando Sin Encargos

Ivelisse Rivera & La
Fundacion Ismael Rivera

Taller Comunidad
La Goyco

Prof. Leslie Dodson

Prof. Scott Jiusto

All the residents
surrounding the Casa
Museo Ismael Rivera



Thank You

